

GALAXY ZIBÓ

A journey of luxury and nature along Costa Rica's Pacific coast — where every moment awakens your senses.



Specifications

LENGTH	126' / 38.4m
BEAM	24' / 7.32m
DRAFT	66 / 1.98m
GROSS TONNAGE	256 GT
CRUISING SPEED	12 Knots
BUILT	1986 2023 (Refitted)
BUILDER	Broward
MODEL	Custom
EXTERIOR DESIGNER	Broward
INTERIOR DESIGN	Richard Hein, Robert Farrinaci

GUEST

10

CABIN

5

CREW

5⁺ Cruise Director

CABIN CONFIGURATION

• 1 Master • 2 Double • 2 Twin

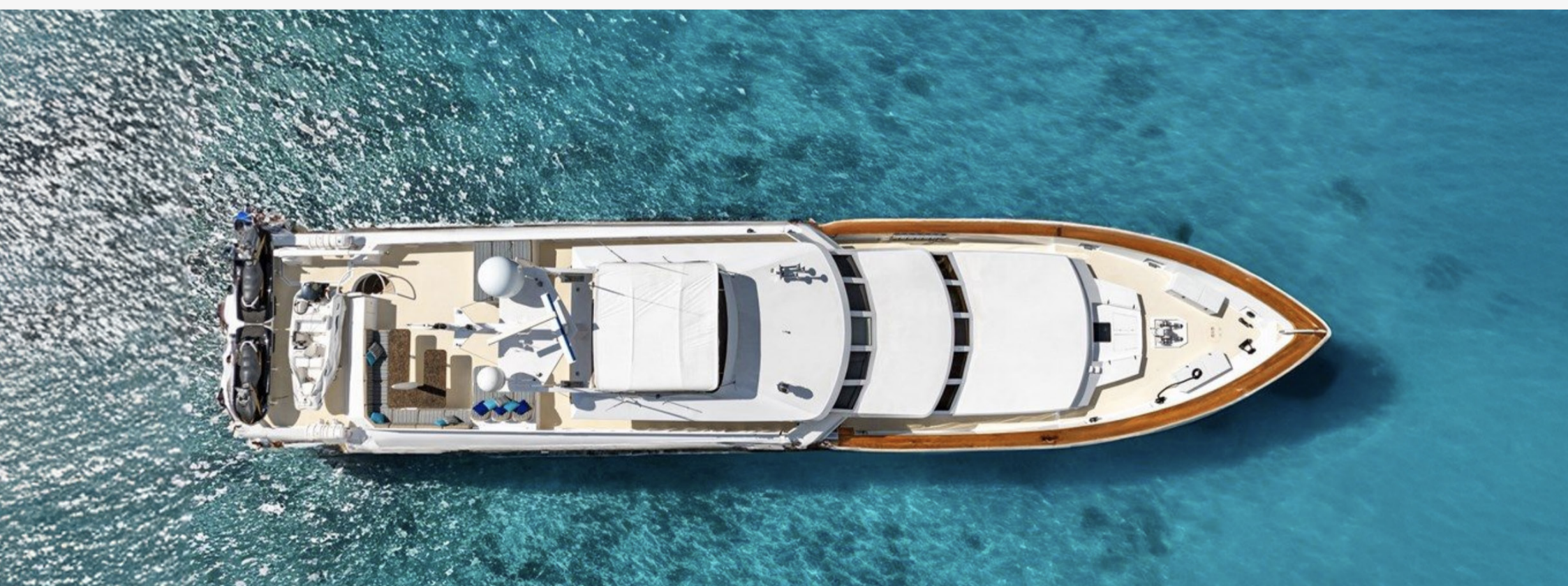

CHARTERS & GROUPS

Take advantage of making business directly with the 100% Operators including special rates and benefits for you.

Deck Plan

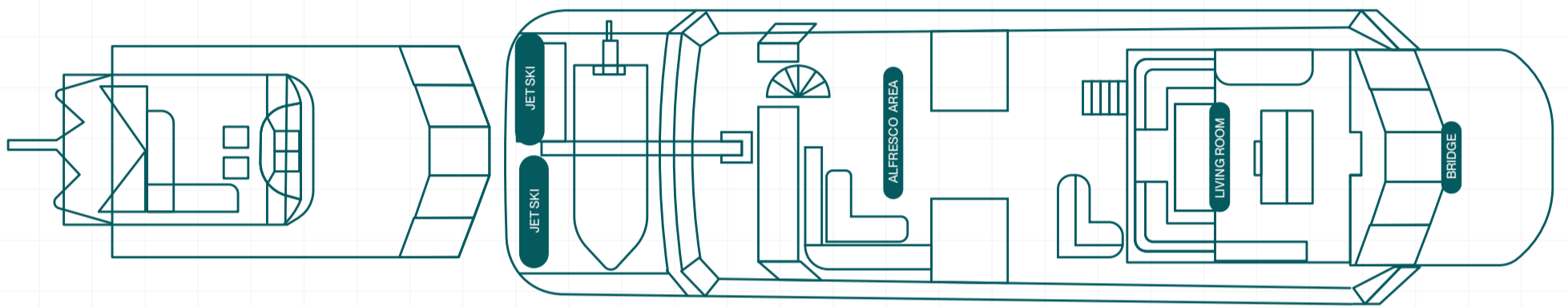

UPPER DECK

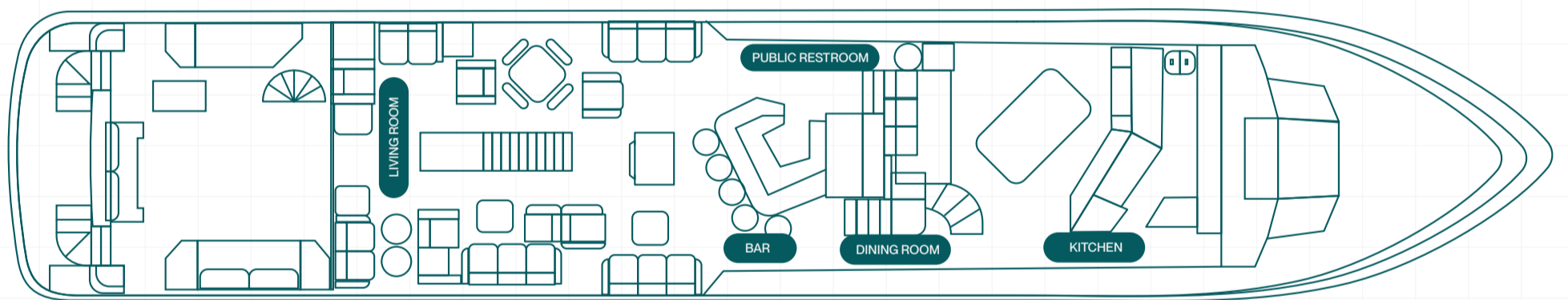

MAIN DECK

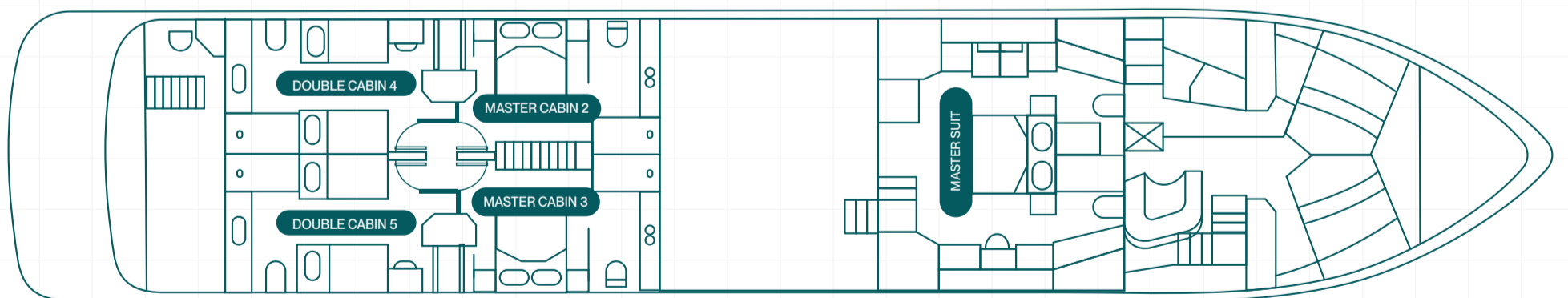

LOWER DECK



Itinerary A

- Day 1** Transfer to hotel in San José
- Day 2** Transfer to airport- Domestic flight from San José to Golfito
- Day 3** Corcovado National Park
- Day 4** Caño Island
- Day 5** Sierpe Wetlands - Las Esferas Archaeological Park
- Day 6** Manuel Antonio National Park (except Tuesdays)
Punta Quepos (Tuesdays only)
- Day 7** Quepos - San José



Itinerary B

- Day 1** Transfer to hotel in San José
- Day 2** Transfer to airport - Domestic flight from San José to Quepos
- Day 3** Manuel Antonio National Park (except Tuesdays)
Punta Quepos (Tuesdays only)
- Day 4** Sierpe Wetlands - Las Esferas Archaeological Park
- Day 5** Caño Island
- Day 6** Corcovado National Park
- Day 7** Golfito - San José

GALAXY ZIBÓ



Hiking



Swimming



Snorkeling



Kayaking



Paddle Boarding



Jetski



Sea scooter

Included

- One night accommodation in San José prior the cruise.
- All airport transfers on the cruise departure dates.
- Local flights from/to San José to Quepos or Golfito, depending on the itinerary.
- Airport assistance on the cruise departure dates.
- Transportation and fuel surcharge.
- Accommodation in single, double or triple cabin according to your booking.
- Cruise Director.
- Personalized crew service.
- All meals during the cruise, from lunch on the first day to breakfast on the last day.
- One snack after each activity (except last day).
- Welcome cocktail.
- Unlimited purified water, coffee and tea.
- Soft drinks.
- All visits, excursions & activities according to the itinerary.
- Snorkeling gear (Mask, tube, and fins).
- Use of kayaks, paddle boards and slide in authorized places.
- Use of jet ski and sea scooters in authorized places.
- Shampoo, hair conditioner, and soap for daily use.
- Beach towels.
- Hair dryer in the cabins.

Not Included

- International flights to / from Costa Rica.
- Alcoholic drinks.
- Tips and gratuities.
- Personal expenses.
- Travel insurance (highly recommended).
- Additional services not indicated.

Conditions

- Single supplement 50% (Cabins 2, 3, 4 and 5).
- Single supplement 100% (Cabin 1).
- Christmas and New Year surcharge 50%.
- Discount for charter 5%.
- Discount for children (2 - 11 years): 10%.
- Discount for infants (0 - 2 years): 70%.
- Promotional prices are only valid for new bookings and cannot be extended to confirmed reservations.

FITS

- First deposit required to confirm 20% of the total amount.
- Balance must be paid 60 days prior to the cruise departure.
- Cancellations 120 days or more, before the cruise: 10% penalty fee.
- Cancellations 119 to 60 days before the cruise: 20% penalty fee.
- Cancellations less than 60 days before cruise departure, penalty 100%.
- Does not apply discount over discount.
- Applies for new reservations.

Charter

- First deposit required to confirm 20% of the total amount.
- Balance must be paid 90 days prior to the cruise departure.
- Cancellations 180 days or more, before the cruise: 10% penalty fee (Balance can be used as credit or refunded).
- Cancellations 179 to 90 days before the cruise: 20% penalty fee.
- Cancellations less than 90 days before cruise departure, penalty 100%.
- Does not apply discount over discount.
- Applies for new reservations.

\$6300 7D/6N

GALAXY ZIBÓ



GALAXY ZIBÓ



GALAXY ZIBÓ





GALAXY ZIBÓ

GALAXY ZIBÓ



GALAXY ZIBÓ





GALAXY ZIBÓ

Each day is an exclusive journey through jungles, beaches, and ocean — designed to connect your senses with the extraordinary.